

Aleixo Arena Entry Plan

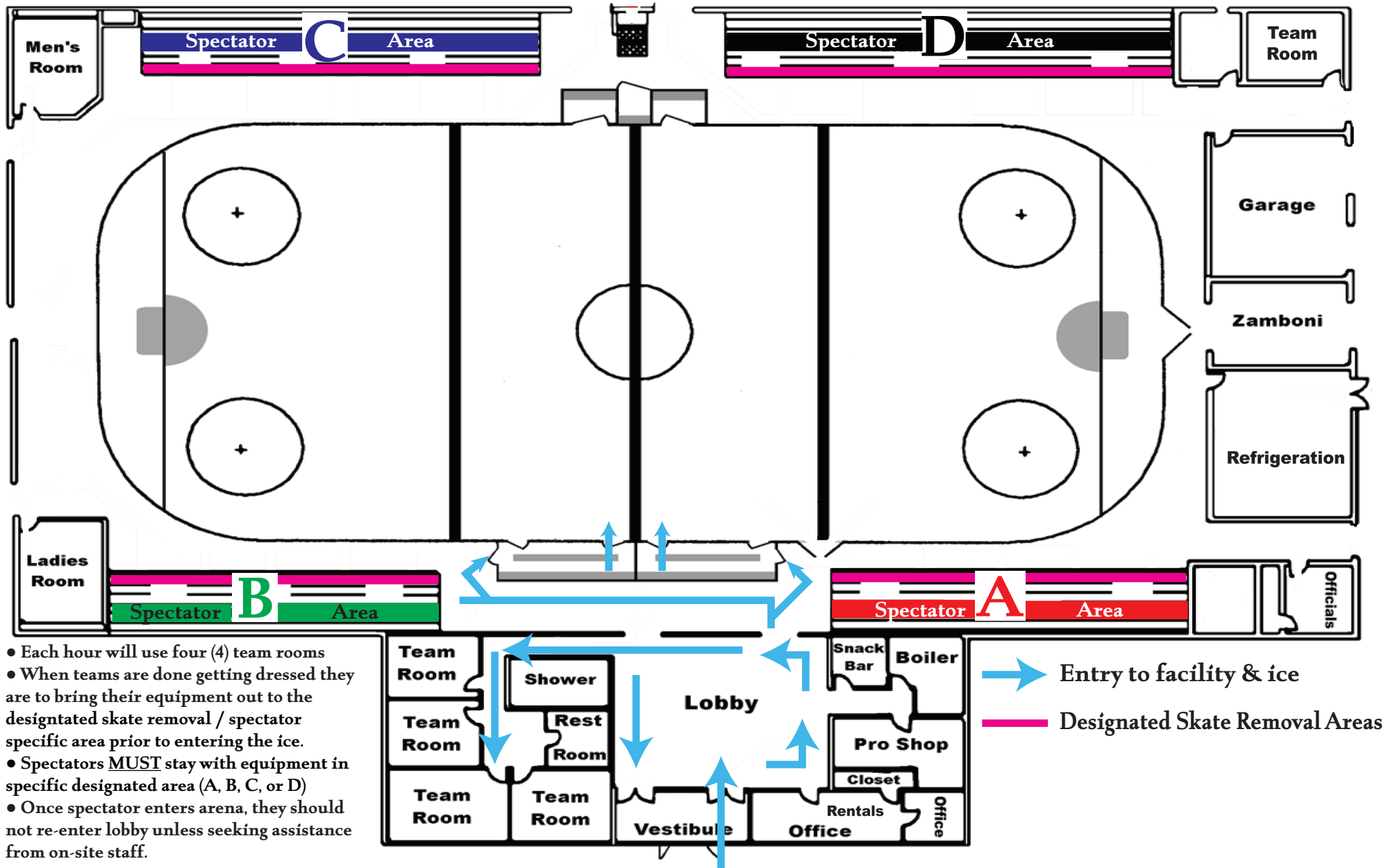

- Each hour will use four (4) team rooms
- When teams are done getting dressed they are to bring their equipment out to the designated skate removal / spectator specific area prior to entering the ice.
- Spectators **MUST** stay with equipment in specific designated area (A, B, C, or D)
- Once spectator enters arena, they should not re-enter lobby unless seeking assistance from on-site staff.

Aleixo Arena Entry Plan

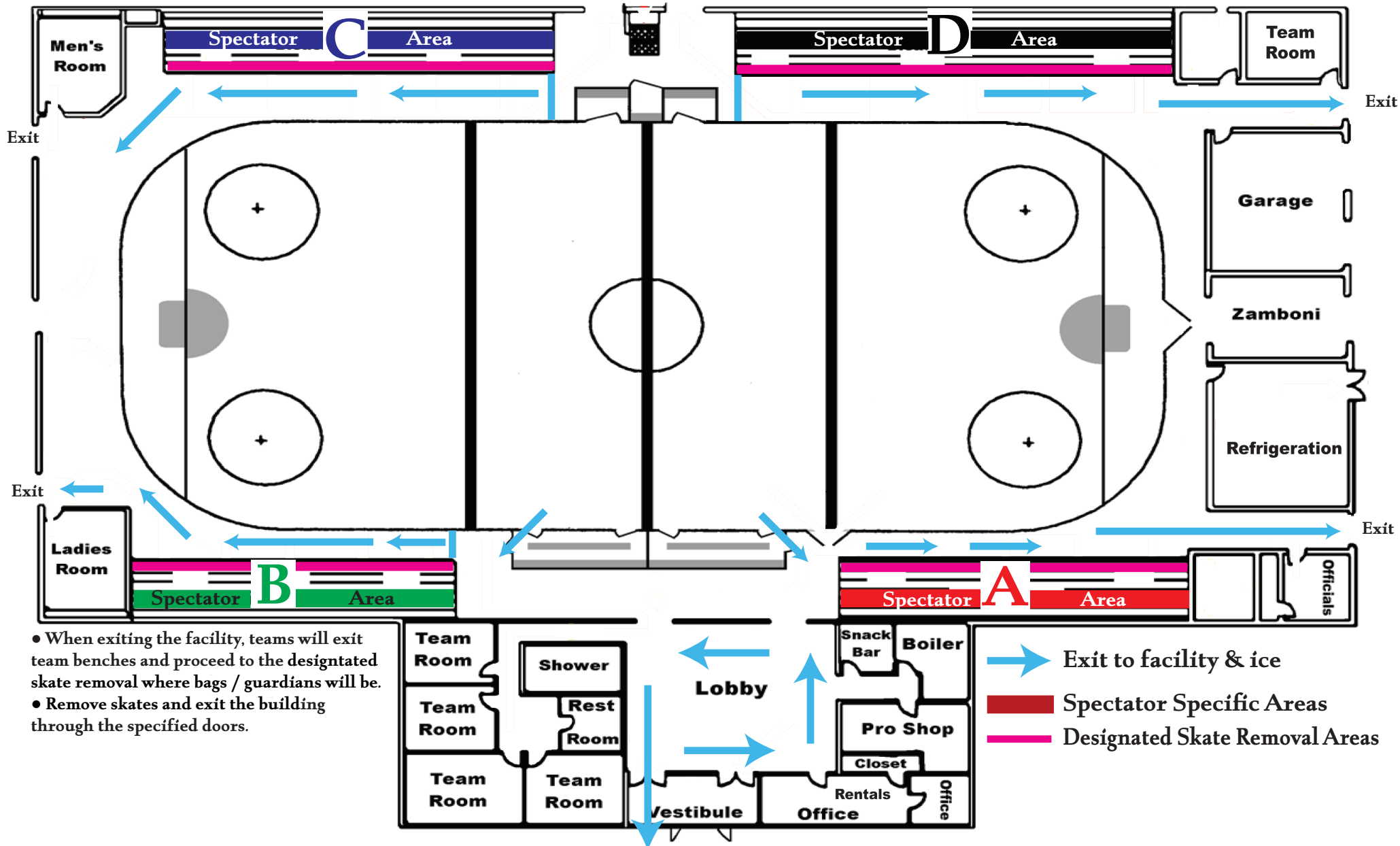

- When exiting the facility, teams will exit team benches and proceed to the designated skate removal where bags / guardians will be.
- Remove skates and exit the building through the specified doors.

- ➡ Exit to facility & ice
- ➡ Spectator Specific Areas
- ➡ Designated Skate Removal Areas